

Friday P.M. Sept 6th 1889

21st St.

Levinway Ave.

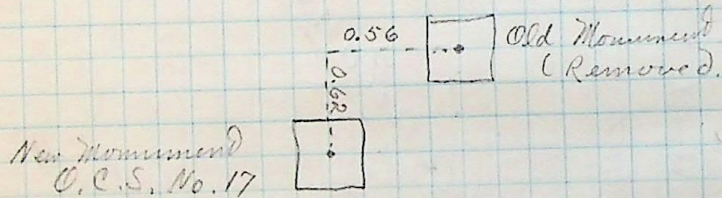

A. F. PARKER.

B27

21st Street

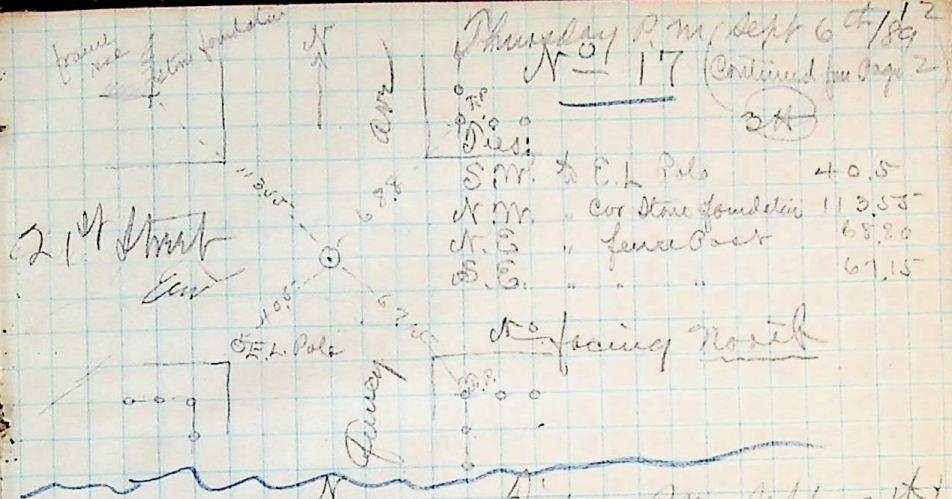

Thursday P.M. Sept 6th 1889
No. 17 (Continued from Page 2)

| | |
|---------------------------|--------|
| Dist. to E.L. Pole | 40.5 |
| N.M. Cor Stone foundation | 113.55 |
| J.E. fence post | 68.80 |
| S.E. " " | 67.15 |

Friday P.M. Sept 7th 1889
No. 18

24th Street

at sign post

Trall

Hydrant No facing north

| | |
|-------------------------|------|
| Dist. to Fence post | 70.6 |
| S.E. " Hydrant | 46.6 |
| S.M. " Street sign post | 53.6 |
| N.E. " E.L. Pole | 5.8 |

A. F. PARKER.